

Display Body Form Combination Installation Guide

Please check the following items in your package. If anything is missing or damaged, contact your dealer immediately.

- | | |
|-----------------------------|-------|
| (1) BASE | 1 pc. |
| (2) SPRING | 1 pc. |
| (3) POLE | 1 pc. |
| (4) SHELF-1 | 1 pc. |
| (5) SHELF-2 | 1 pc. |
| (6) CHILDREN'S DISPLAY FORM | 1 pc. |



(1)



(2)



(4)



(5)



(3)



(6)

PGM_{Plus}



Step 2
Gently place **SPRING** on top
of the **BASE**.

Step 1
Place **BASE** firmly on the ground.

Step 3
Insert **POLE** into the
BASE through **SPRING**.



*Make sure to twist the screw tightly after
POLE is inserted into the BASE completely.*

Make sure to have POLE standing on the end of the foot pedal.

Step 4

After Step 3, you are ready to install SHELVES. Install SHELF-1 first.

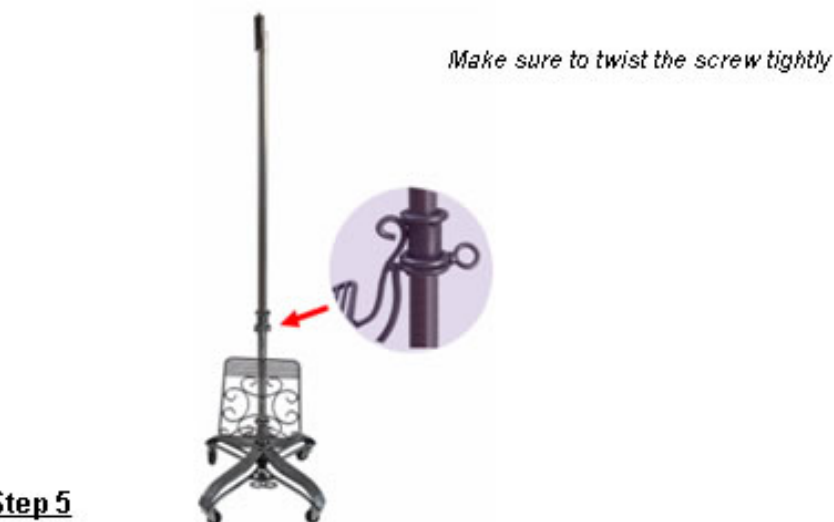

Step 5

After Step 4, slide SHELF-2 over the POLE, and twist the screw tightly.

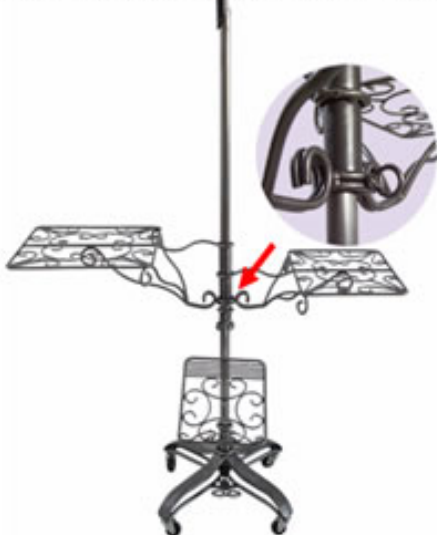



Step 6

After Step 5, put CHILDREN'S DISPLAY FORM over the POLE.

Step 7

You may also slide CHILDREN'S DISPLAY FORM over the POLE from the leg.

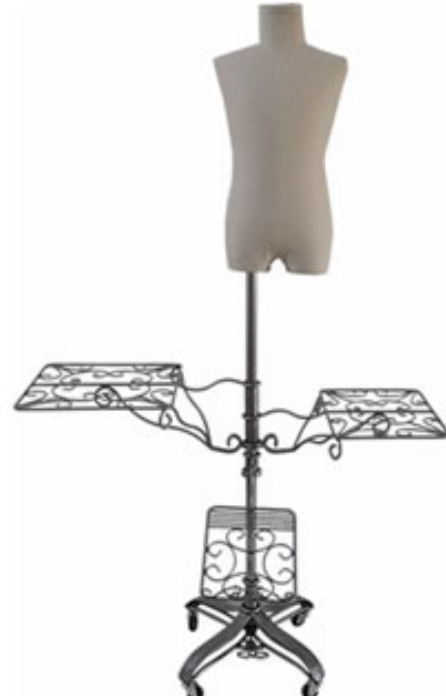

Congratulations !! Installation Complete

701H PGM Children Display Form w Racks

Assembling Guide